



INSTALLATION INSTRUCTIONS

[CARBAHN.COM/INSTRUCTIONS](https://carbahn.com/instructions)

M5 and M8 Strut Brace Set

CARBAHN PART #:

CBB04-00-5080

CBB04-00-5081



US Based Support
866-558-4314
Sales@CarBahn.com
CarBahn.com

These instructions assume that the person installing these parts is a *BMW CERTIFIED MECHANIC* and are *NOT* step by step instructions on how to disassemble and reassemble the car.

1. See TIS instructions for removing and replacing the front-end struts as appended below.
Instead of replacing the OEM Strut Brace, place the new CarBahn Strut Brace.
WARNING: hand thread bolts only, do not use power tools.

BMW Group - AIR: 2024-07-12 / 13:33
 Dealer: 32711/06
 Model: M8
 Vehicle identification number: WBSAE0C03LCD94111
 Development code: F92
 Model code: AE03
 Lead type: AE03

Removing and refitting/replacing left or right front end strut »

i TECHNICAL INFORMATION

Driving without the strut brace/front-end strut or tension strut is not permitted.

📄 NOTE

Description is for left component only. Procedure on the right side is identical.

Preliminary work

Release left front-end strut

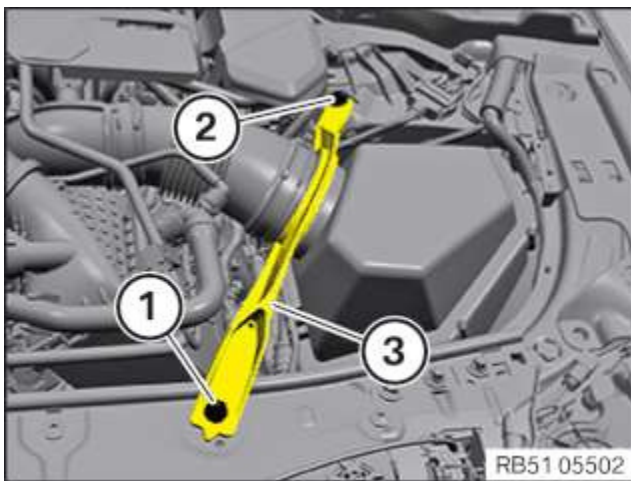

📄 RISK OF DAMAGE

Use of an incorrect tool (impact screwdriver) to release and tighten the screws.
 Damaged thread.

- Only use a standard tool (e.g. reversible ratchet) to release/tighten the screws.
- Release screws(1) and (2) the strut brace(3) .

Remove left intake silencer housing

► Removing the left intake filter housing (equipment specification with refrigerant bulkhead)

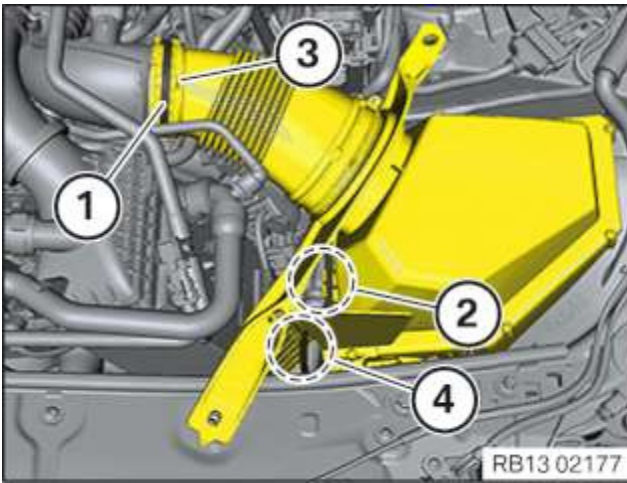

- Loosen hose clamp (1).
- Unclip the line in area (2).
- Detach the bellows (3) from the clean air tube.
- Feed out the line in area (4) downward at the bulkhead.

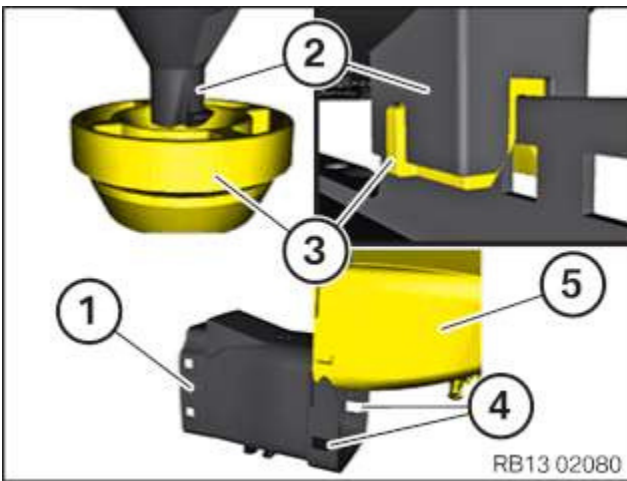

- Carefully release the centering pin (2) at the intake filter housing (5) upwards and out of the decoupling elements (3).
- Unlock the detents (4) at the clean air tube (1).
- Remove intake silencer housing (5) towards top.

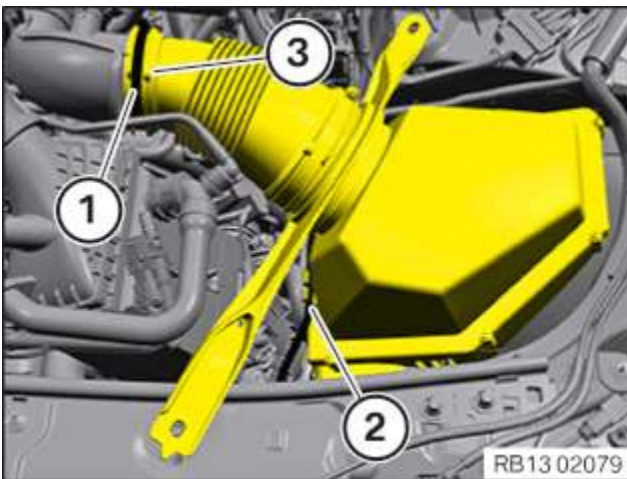

- Loosen hose clamp (1).
- Unclip the line (2).
- Detach the bellows (3) from the clean air tube.

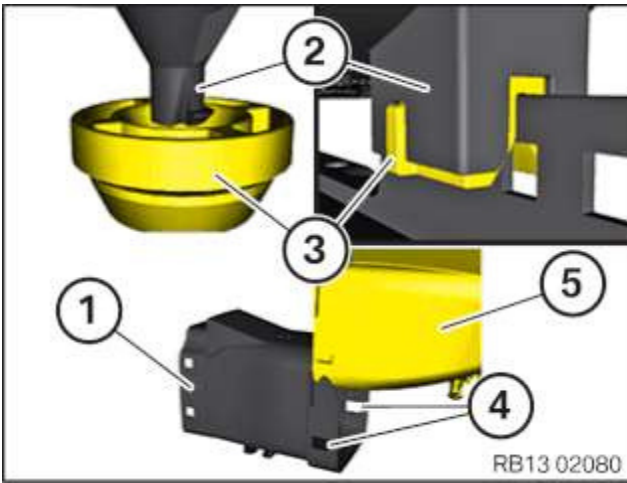

- Carefully release the centering pin (2) at the intake filter housing (5) upwards and out of the decoupling elements (3).
- Unlock the detents (4) at the clean air tube (1).
- Remove intake silencer housing (5) towards top.

Main Works

Remove left front-end strut

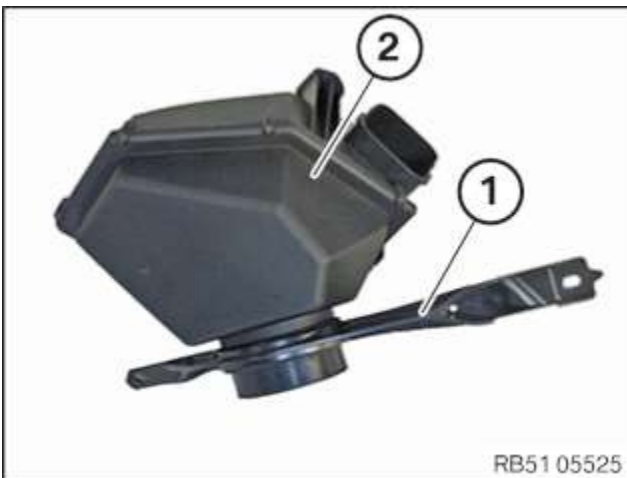

- Remove the front-end strut (1) from the intake filter housing (2).

Install the left front-end strut



- Slide the front-end strut (1) onto the intake filter housing (2).

Check the foam seal on the intake filter housing, it must not be damaged or missing.

Follow-up works

Install left intake silencer housing

► Install intake filter housing left (version with refrigerant partition)

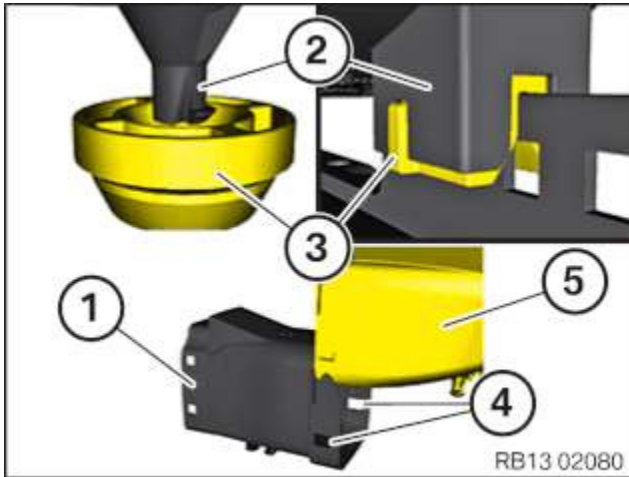

- Position the intake filter housing (5).
- Lock the detents (4) at the clean air tube (1).
- Carefully engage the centering pin (2) on the intake filter housing (5) downwards into the decoupling elements (3).

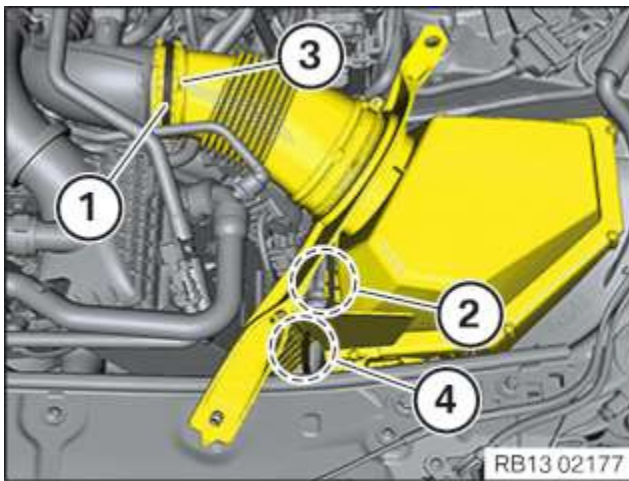

- Insert wire in area (4) upwards on the bulkhead.
- Position the bellows (3) on the clean air tube.
- Clip in the line (2).
- Tighten the hose clamp (1).

Tightening torques

Hose clamp

Hose clamp	Tightening torque
	3Nm

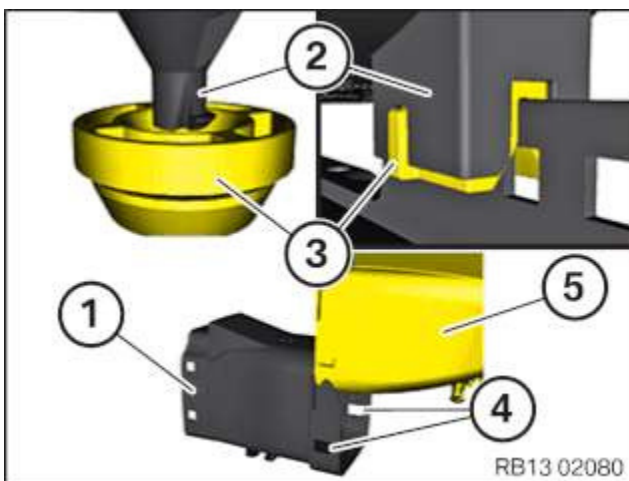

- Position the intake filter housing (5).
- Lock the detents (4) at the clean air tube (1).
- Carefully engage the centering pin (2) on the intake filter housing (5) downwards into the decoupling elements (3).

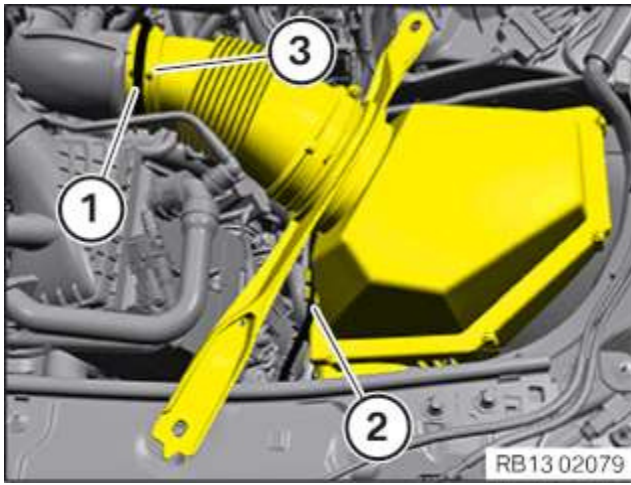

AIR - Technical documents

- Position the bellows (3) on the clean air tube.
- Clip in the line (2).
- Tighten the hose clamp (1).

Tightening torques

Hose clamp

Hose clamp

Tightening torque

3Nm

Tighten the left front-end strut

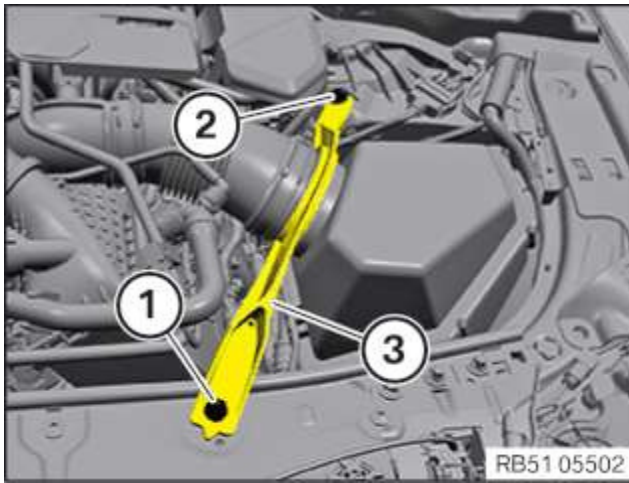

RISK OF DAMAGE

Use of an incorrect tool (impact screwdriver) to release and tighten the screws.
Damaged thread.

- Only use a standard tool (e.g. reversible ratchet) to release/tighten the screws.

- Clean the thread at shock tower.
- Renew the screw (1).

Parts: Screw

Tighten the bolt (1) of the strut brace (3).

Tightening torques

Front-end strut, front

Screw	Snug torque 28Nm Angle of rotation 90°
-------	--

- Renew the screw (2).

Parts: Screw

Tighten the bolt (2) of the strut brace (3).

Tightening torques

Front-end strut, rear

Screw	Snug torque 56Nm Angle of rotation 90°
-------	--

- Repair the damaged thread on the shock tower with a Helicoil insert.

Consumable

Helicoil thread insert M10x30 mm07129909659